

CUTTING PROFILES



Aluminium

DIN C



DIN MY

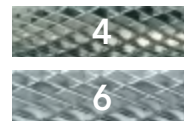

Diamond

DIN MX

More detailed information about the different cutting profiles: page 86



TUNGSTEN CARBIDE  
ROTARY BURRS:  
CYLINDRICAL,  
WITHOUT FRONT CUT.

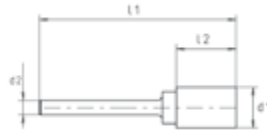

d1 mm	l2 mm	d2 mm	l1 mm	1A	1	2	3	4	6	
				ART. CODE	ART. CODE	ART. CODE	ART. CODE	ART. CODE	ART. CODE	
2	10	3	38	●		●	●	●	●	1pc
2,5	12	3	38	●		●	●	●	●	1pc
3	14	3	38	●		●	●	●	●	1pc
3	14	3	50	●		●	●	●	●	1pc
3	14	3	65	●		●	●	●	●	1pc
4	10	3	40	●		●	●	●	●	1pc
4	14	6	50	●		●	●	●	●	1pc
5	12	3	42	●		●	●	●	●	1pc
6	13	3	43	●		●	●	●	●	1pc
6	16	6	50	●		●	G481063	●	G481066	1pc
8	20	6	65	●		●	G481083	●	G481086	1pc
10	13	6	58	●		●	●	●	●	1pc
10	20	6	65	●		●	G481103	●	G481106	1pc
12	25	6	70	●		●	G481123	●	G481126	1pc
12	25	8	70	●		●	●	●	●	1pc
16	25	6	70	●		●	●	●	●	1pc
16	25	8	70	●		●	●	●	●	1pc
20	25	6	70	●		●	●	●	●	1pc



TUNGSTEN CARBIDE  
ROTARY BURRS:  
CYLINDRICAL,  
WITH FRONT CUT.



d1 mm	l2 mm	d2 mm	l1 mm	1A	1	2	3	4	6	
				ART. CODE	ART. CODE	ART. CODE	ART. CODE	ART. CODE	ART. CODE	
2	10	3	38	●		●	●	●	●	1pc
2	10	3	50	●		●	●	●	●	1pc
2,5	12	3	38	●		●	●	●	●	1pc
2,5	12	3	65	●		●	●	●	●	1pc
2,5	12	3	75	●		●	●	●	●	1pc
3	14	3	38	●		●	●	●	●	1pc
3	14	3	50	●		●	●	●	●	1pc
3	14	3	75	●		●	●	●	●	1pc
4	14	6	50	●		●	●	●	●	1pc
6	13	3	43	●		●	●	●	●	1pc
6	16	6	50	●		●	G482063	●	G482066	1pc
8	20	6	65	●		●	G482083	●	G482086	1pc
10	13	6	58	●		●	●	●	●	1pc
10	20	6	65	●		●	G482103	●	G482106	1pc
12	25	6	70	●		●	G482123	G482124	G482126	1pc
16	25	6	70	●		●	●	●	G482166	1pc
16	25	8	70	●		●	●	●	●	1pc
20	25	8	70	●		●	●	●	●	1pc

▼ = articles always in stock

● = available in 20 days

CUTTING PROFILES



Aluminium

DIN C



DIN MY

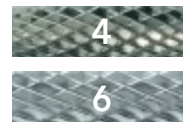

Diamond

DIN MX

More detailed information about the different cutting profiles: page 86



TUNGSTEN CARBIDE  
ROTARY BURRS:  
BALL NOSE.

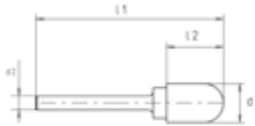

d1 mm	l2 mm	d2 mm	l1 mm	1A	1	2	3	4	6	
				ART. CODE	ART. CODE	ART. CODE	ART. CODE	ART. CODE	ART. CODE	
3	14	3	38	●	●	●	●	●	●	1pc
3	14	3	50	●	●	●	●	●	●	1pc
4	10	3	40	●	●	●	●	●	●	1pc
4	14	6	50	●	●	●	●	●	●	1pc
5	12	3	42	●	●	●	●	●	●	1pc
6	14	3	43	●	●	●	●	●	●	1pc
6	16	6	50	●	●	●	G483063	●	G483066	1pc
6	16	6	150	●	●	●	●	●	●	1pc
8	20	6	65	●	●	●	G483083	●	G483086	1pc
10	20	6	65	●	●	●	G483103	●	G483106	1pc
10	25	6	70	●	●	●	●	G483104	●	1pc
10	20	6	150	●	●	●	●	●	●	1pc
12	25	6	70	G483121 A	●	●	G483123	G483124	G483126	1pc
12	25	6	150	●	●	●	●	●	●	1pc
12	25	8	70	●	●	●	●	●	●	1pc
16	25	6	70	●	●	●	●	●	●	1pc
16	25	8	70	●	●	●	●	●	●	1pc
20	25	6	70	●	●	●	●	●	●	1pc



TUNGSTEN CARBIDE  
ROTARY BURRS:  
ARC POINTED  
NOSE.

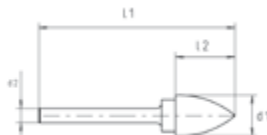

d1 mm	l2 mm	d2 mm	l1 mm	1A	1	2	3	4	6	
				ART. CODE	ART. CODE	ART. CODE	ART. CODE	ART. CODE	ART. CODE	
3	12	3	38	●		●	●	●	●	1pc
4	10	3	40	●		●	●	●	●	1pc
4	14	6	50	●		●	●	●	●	1pc
5	12	3	42	●		●	●	●	●	1pc
6	13	3	43	●		●	●	●	●	1pc
6	16	6	50	●		●	●	G489064	●	1pc
8	20	6	65	●		●	●	●	●	1pc
10	20	6	65	●		●	●	●	●	1pc
12	25	6	70	G489121 A		●	●	G489124	G489126	1pc
12	25	8	70	●		●	●	●	●	1pc
16	30	6	75	●		●	●	●	G489166	1pc
16	30	8	75	●		●	●	●	●	1pc

CUTTING PROFILES



Aluminium

DIN C



DIN MY

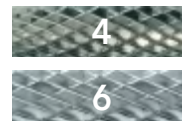

Diamond

DIN MX

More detailed information about the different cutting profiles: page 86



TUNGSTEN CARBIDE  
ROTARY BURRS:  
INVERTED CONE,  
WITHOUT FRONT CUT

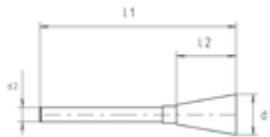

d1 mm	l2 mm	d2 mm	l1 mm	1A ART. CODE	1 ART. CODE	2 ART. CODE	3 ART. CODE	4 ART. CODE	6 ART. CODE	
3	3	3	38				●		●	1pc
6	6	3	36				●		●	1pc
8	8	6	53				G4811083		●	1pc
10	10	6	55				●		●	1pc
12	12	6	57				●		●	1pc



TUNGSTEN CARBIDE  
ROTARY BURRS:  
CONICAL POINTED NOSE

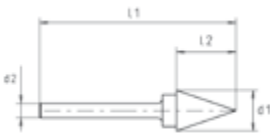

d1 mm	l2 mm	d2 mm	l1 mm	1A ART. CODE	1 ART. CODE	2 ART. CODE	3 ART. CODE	4 ART. CODE	6 ART. CODE	
3	12	3	38			●	●	●	●	1pc
3	12	3	50			●	●	●	●	1pc
4	10	3	40			●	●	●	●	1pc
6	13	3	43			●	●	●	●	1pc
6	16	6	50			●	●	●	●	1pc
8	18	6	63			●	●	●	●	1pc
10	20	6	66			●	●	●	G4810106	1pc
12	25	6	70			●	●	G4810124	●	1pc
16	25	6	70			●	●	●	●	1pc



TUNGSTEN CARBIDE  
ROTARY BURRS:  
CONE 90°.

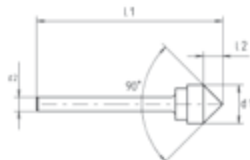

d1 mm	l2 mm	d2 mm	l1 mm	1A ART. CODE	1 ART. CODE	2 ART. CODE	3 ART. CODE	4 ART. CODE	6 ART. CODE	
3	2	3	38				●		●	1pc
4	3	6	50				●		●	1pc
5	4	3	34				●		●	1pc
6	5	6	50				●		●	1pc
8	8	6	53				●		●	1pc
10	10	6	55				G486103		●	1pc
12	12	6	57				●		●	1pc
16	16	6	61				●		●	1pc
20	20	6	65				●		●	1pc

▼ = articles always in stock

● = available in 20 days

## CUTTING PROFILES



Aluminium

DIN C



DIN MY

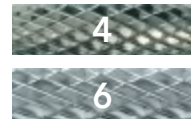

Diamond

DIN MX

More detailed information about the different cutting profiles: page 86

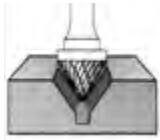

**TUNGSTEN CARBIDE  
ROTARY BURRS:  
CONE 60°.**

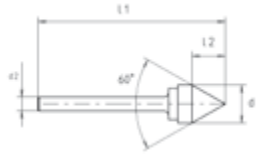

d1 mm	l2 mm	d2 mm	l1 mm	1A ART. CODE	1 ART. CODE	2 ART. CODE	3 ART. CODE	4 ART. CODE	6 ART. CODE	
3	3	3	38				●		●	1pc
4	4	6	50				●		●	1pc
6	6	6	50				●		●	1pc
10	10	6	55				●		●	1pc
12	12	6	57				●		●	1pc
16	16	6	61				●		●	1pc



**TUNGSTEN CARBIDE  
ROTARY BURRS:  
OVAL.**

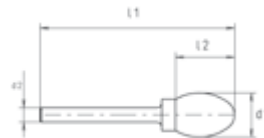

d1 mm	l2 mm	d2 mm	l1 mm	1A ART. CODE	1 ART. CODE	2 ART. CODE	3 ART. CODE	4 ART. CODE	6 ART. CODE	
3	6	3	38				●	●	●	1pc
4	6	3	36				●	●	●	1pc
4	6	6	50				●	●	●	1pc
6	10	3	40				●	●	●	1pc
6	10	6	50				G484063	●	G484066	1pc
8	13	6	58				G484083	●	G484086	1pc
10	16	6	61				G484103	●	G484106	1pc
12	20	6	65				G484123	G484124	G484126	1pc
16	25	6	70				●	●	●	1pc



CUTTING PROFILES



Aluminium



2

DIN MY



4

Diamond



1

DIN C



3



6

DIN MX

More detailed information about the different cutting profiles: page 86



TUNGSTEN CARBIDE  
ROTARY BURRS:  
SPHERICAL.

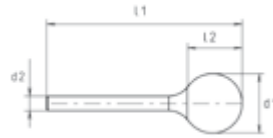

d1 mm	l2 mm	d2 mm	l1 mm	1A ART. CODE	1 ART. CODE	2 ART. CODE	3 ART. CODE	4 ART. CODE	6 ART. CODE	
2,5	2	3	38	●		●	●	●	●	1pc
3	2,5	3	38	●		●	●	●	●	1pc
4	3	3	33	●		●	●	●	●	1pc
4	3	6	50	●		●	●	●	●	1pc
5	4	3	34	●		●	●	●	●	1pc
6	5	3	35	●		●	●	●	●	1pc
6	5	6	50	●		●	G485063	●	G485066	1pc
8	7	6	52	●		●	G485083	●	G485086	1pc
10	9	6	54	●		●	G485103	●	G485106	1pc
10	9	6	150	●		●	●	●	●	1pc
12	10	6	55	●		●	G485123	●	G485126	1pc
12	10	6	150	●		●	●	●	●	1pc
16	14	6	59	●		●	●	●	●	1pc
16	14	8	59	●		●	●	●	●	1pc
20	18	6	63	●		●	●	●	●	1pc



TUNGSTEN CARBIDE  
ROTARY BURRS:  
ARC ROUND NOSE.



d1 mm	l2 mm	d2 mm	l1 mm	1A ART. CODE	1 ART. CODE	2 ART. CODE	3 ART. CODE	4 ART. CODE	6 ART. CODE	
3	12	3	38	●	●	●	●	●	●	1pc
4	10	3	40	●	●	●	●	●	●	1pc
6	13	3	43	●	●	●	●	●	●	1pc
6	18	6	50	●	●	●	●	●	●	1pc
6	13	6	150	●	●	●	●	●	●	1pc
8	18	6	63	●	●	●	●	●	●	1pc
10	20	6	65	●	●	●	●	●	●	1pc
10	20	6	15	●	●	●	●	●	●	1pc
12	25	6	70	G488121 A	●	●	●	G488124	G488126	1pc
12	25	6	150	●	●	●	●	●	●	1pc
12	25	8	70	●	●	●	●	●	●	1pc
16	30	6	75	●	●	●	●	●	G488166	1pc
16	30	8	75	●	●	●	●	●	●	1pc
20	30	6	75	●	●	●	●	●	●	1pc

▼ = articles always in stock

● = available in 20 days



CUTTING PROFILES

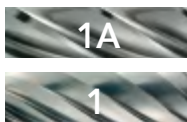

1A Aluminium  
1 DIN C

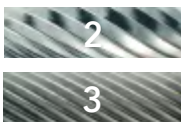

2  
3 DIN MY



4 Diamond  
6 DIN MX

More detailed information about the different cutting profiles: page 86



TUNGSTEN CARBIDE  
ROTARY BURRS:  
CONICAL ROUND NOSE.

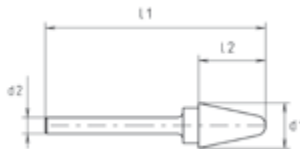

DIN KEL  
ISO L

d1 mm	l2 mm	d2 mm	l1 mm	1A ART. CODE	1 ART. CODE	2 ART. CODE	3 ART. CODE	4 ART. CODE	6 ART. CODE	
3	14	3	38	●	●	●	●	●	●	1pc
4	14	3	44	●	●	●	●	●	●	1pc
4	16	6	50	●	●	●	●	●	●	1pc
6	18	3	48	●	●	●	●	●	●	1pc
6	20	6	50	●	●	●	●	●	●	1pc
8	20	6	65	●	●	●	●	●	●	1pc
10	20	6	65	G487121 A	●	●	G487103	●	●	1pc
12	25	6	70	●	●	●	●	●	G487126	1pc
12	25	6	75	●	●	●	●	●	●	1pc
16	30	8	75	●	●	●	●	●	●	1pc



TUNGSTEN CARBIDE  
ROTARY BURRS:  
FLAME.

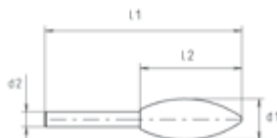

DIN B  
ISO H

d1 mm	l2 mm	d2 mm	l1 mm	1A ART. CODE	1 ART. CODE	2 ART. CODE	3 ART. CODE	4 ART. CODE	6 ART. CODE	
6	20	6	57				●	●	●	1pc
8	20	6	65				●	●	●	1pc
10	25	6	70				●	●	●	1pc
12	30	6	75				●	G4811124	●	1pc
16	30	6	77				●	●	●	1pc



▼ = articles always in stock

● = available in 20 days